

## Metal Seated Gate Valve (MSGV)

**D**erwent Industries Metal Seated Gate Valves are manufactured in accordance with AS/NZS 2638.1. The Gate Valves are light weight and applicable for water and waste water applications.

### Features:

- Ductile Iron body and bonnet to AS 1831:500-7
- Gate is Ductile Iron AS 1831:500-7
- Forged Stem: Stainless Steel to ASTM A276, providing excellent corrosion and strength, reducing moving parts.
- Bolts where applicable are hot melt encapsulated for superior corrosion resistance in harsh environments.
- Fusion Bonded Epoxy coated to AS/NZS 4158 provides the valve excellent corrosion protection.
- Valves are available in both Anticlockwise and Clockwise configuration. Valves are supplied with Key Cap as standard, Hand Wheel and gear boxes are optional.
- Bearing is C62300 Aluminium Bronze for superior strength and corrosion resistance.

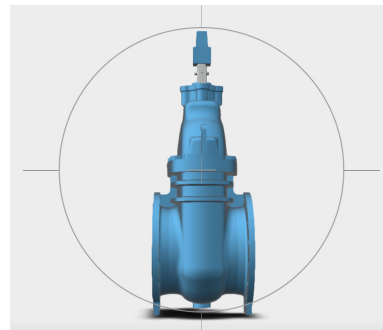
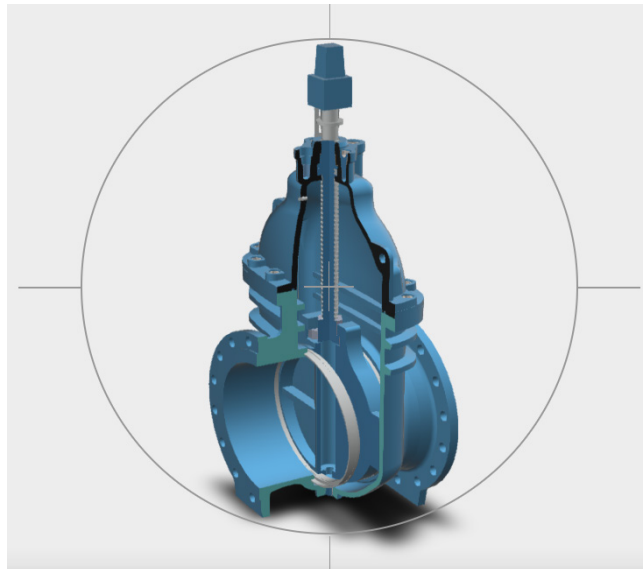

### Applications:

The Derwent Industries MSGV are for use in Potable Water, Waste Water, Fire, Irrigation, Water Circulation and Heating and Cooling applications and are suitable for both above and below ground installation where a MSGV is required.

### Technical Information:

#### Size range:

Flanged                    DN 80 - 900  
                                   DN 1000 - 2000  
                                   BS 5163 (Drilling to AS/NZS4087)

**Allowable Operating Pressure:**                    1600 kPa; 1.6 Mpa

**Maximum Test Pressure:**                            2400 kPa, 2.4 Mpa

**Certification:**    SAI Global  
     DN 80-200, 250-450  
     SMK/WMK 26590

# Metal Seated Gate Valves - Flanged DN80 to DN300

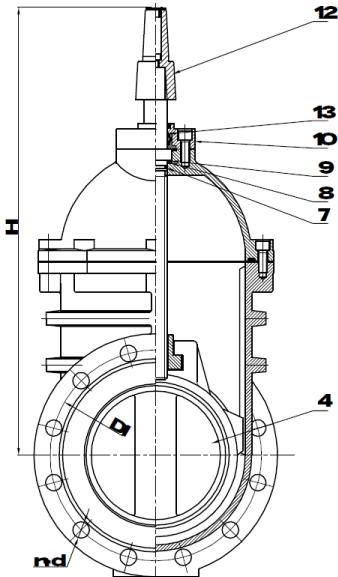
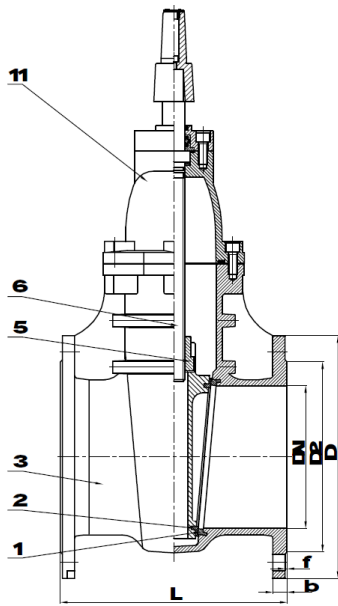

## Part List

No	Parts Names	Material	Standard
1	Body Seal Ring	Aluminium Bronze C62300	AS/NZS 1568
2	Gate Seal Ring	Aluminium Bronze C62300	AS/NZS 1568
3	Body	Ductile Iron	AS 1831:500-7
4	Gate	Ductile Iron	AS 1831:500-7
5	Stem Nut	Aluminium Bronze C62300	AS/NZS 1568
6	Stem	Stainless Steel	ASTM A276
7	O-ring	Rubber EPDM	AS 1646 and AS 681.1
8	Back Seat	Rubber EPDM	AS 1646
9	Washer	Nylon	
10	Support	Ductile Iron	AS 1831:500-7
11	Bonnet	Ductile Iron	AS 1831:500-7
12	Square Cap	Ductile Iron	AS 1831:500-7
13	Bearing	Aluminium Bronze C62300	AS/NZS 1568

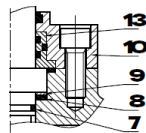

## Technical Requirements:

1. Design Standard: AS 2638.1
2. Face to Face Dimensions: AS 2638.1
3. Flanges Standard: AS 4087 PN16
4. Tests standard: AS 2638.1
5. ISO Mount options available

## Dimensions:

DN	L	D	D1	D2	b	N-Ød	f	H
80	203	185	146	122	18	4-Ø18	3	400
100	229	215	178	154	20	4-Ø18	3	447
150	267	280	235	211	23	8-Ø18	3	520
200	292	335	292	268	23	8-Ø18	3	630
225	305	370	324	300	24	8-Ø18	3	650
250	330	405	356	328	24	8-Ø22	3	728
300	356	455	406	378	30	12-Ø22	4	812

# Metal Seated Gate Valves - Flanged DN375 & 450

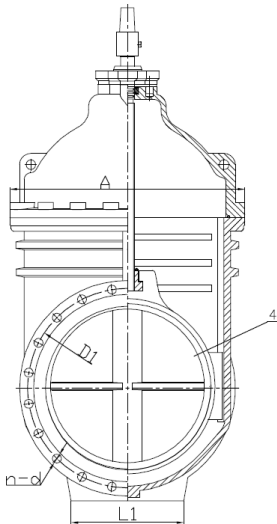
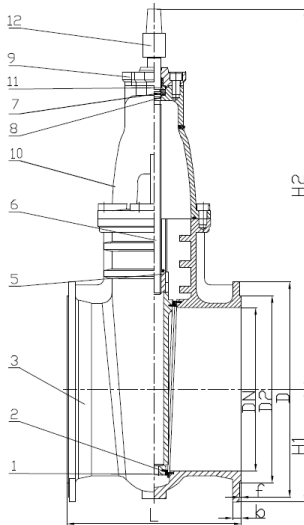

## Part List

No	Parts Names	Material	Standard
1	Body Seal Ring	Aluminium Bronze C62300	AS/NZS 1568
2	Gate Seal Ring	Aluminium Bronze C62300	AS/NZS 1568
3	Body	Ductile Iron	AS 1831:500-7
4	Gate	Ductile Iron	AS 1831:500-7
5	Stem Nut	Aluminium Bronze C62300	AS/NZS 1568
6	Stem	Stainless Steel	ASTM A276
7	Stem Collar	3Stainless Steel	ASTM A276
8	O-Ring	Rubber EPDM	AS 1646
9	Support	Ductile Iron	AS 1831:500-7
10	Support	Ductile Iron	AS 1831:500-7
11	Bearing	Aluminium Bronze C62300	AS/NZS 1568
12	Cap top	Ductile Iron	AS 1831:500-7

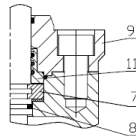

## Technical Requirements:

1. Design Standard: AS 2638.1
2. Face to Face Dimensions: AS 2638.1
3. Flanges Standard: AS 4087 PN16
4. Tests standard: AS 2638.1
5. ISO Mount options available

## Dimension:

DN	L	D	D1	D2	b	f	N-Ød	L1	H1	H2	A
375	381	550	495	463	33	4	12-Ø26	285	285	980	580
450	432	640	584	552	33	4	12-Ø26	330	330	1109	680

## Product Guide - Flanged MSGV

Item	Size	Code	Description
1	80	VMSFF80ACC	80mm FL/FL Metal Seated Gate Valve ACC
2	80	VMSFF80CC	80mm FL/FL Metal Seated Gate Valve CC
3	100	VMSFF100ACC	100mm FL/FL Metal Seated Gate Valve ACC
4	100	VMSFF100CC	100mm FL/FL Metal Seated Gate Valve CC
5	150	VMSFF150ACC	150mm FL/FL Metal Seated Gate Valve ACC
6	150	VMSFF150CC	150mm FL/FL Metal Seated Gate Valve CC
7	200	VMSFF200ACC	200mm FL/FL Metal Seated Gate Valve ACC
8	200	VMSFF200CC	200mm FL/FL Metal Seated Gate Valve CC
9	225	VMSFF225ACC	225mm FL/FL Metal Seated Gate Valve ACC
10	225	VMSFF225CC	225mm FL/FL Metal Seated Gate Valve CC
11	250	VMSFF250ACC	250mm FL/FL Metal Seated Gate Valve ACC
12	250	VMSFF250CC	250mm FL/FL Metal Seated Gate Valve CC
13	300	VMSFF300ACC	300mm FL/FL Metal Seated Gate Valve ACC
14	300	VMSFF300CC	300mm FL/FL Metal Seated Gate Valve CC
15	375	VMSFF375ACC	375mm FL/FL Metal Seated Gate Valve ACC
16	375	VMSFF375CC	375mm FL/FL Metal Seated Gate Valve CC
17	400	VMSFF400ACC	400mm FL/FL Metal Seated Gate Valve ACC
18	400	VMSFF400CC	400mm FL/FL Metal Seated Gate Valve CC
19	450	VMSFF450ACC	450mm FL/FL Metal Seated Gate Valve ACC
20	450	VMSFF450CC	450mm FL/FL Metal Seated Gate Valve CC

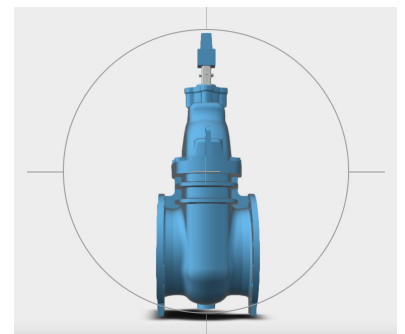
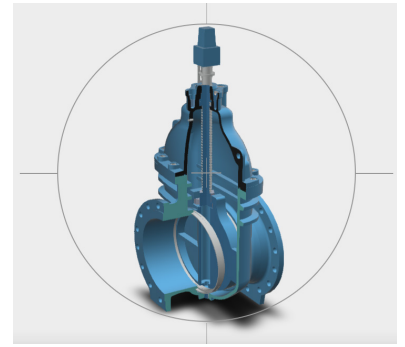

## Product Approvals and Ratings

METAL SEATED GATE VALVES MANUFACTURED IN ACCORDANCE WITH AS/NZS 2638.1

Pressure Rating: Detailed is PN16, MSGV also available in PN35, please contact us for further information

SUITABLE FOR POTABLE (BLUE), RECYCLED (LILAC) WATER AND WASTE WATER

Maximum Operating Pressure: 1600 KPA (PN35 Also available)

Maximum Test Pressure: 2400 KPA

**Installation:** Suitable for above or below ground and shall be in accordance with the relevant regulatory codes and local authority requirements.

The system should be pressure tested before backfilling or concealment.



Web: [www.derwentindustries.com.au](http://www.derwentindustries.com.au)

Australia: [sales@derwentindustries.com.au](mailto:sales@derwentindustries.com.au)

New Zealand: [sales@derwentindustries.co.nz](mailto:sales@derwentindustries.co.nz)